



ITE Western District 2024 Student Leadership Summit

February 4, 2024

Monique Chen, PE / CR Associates



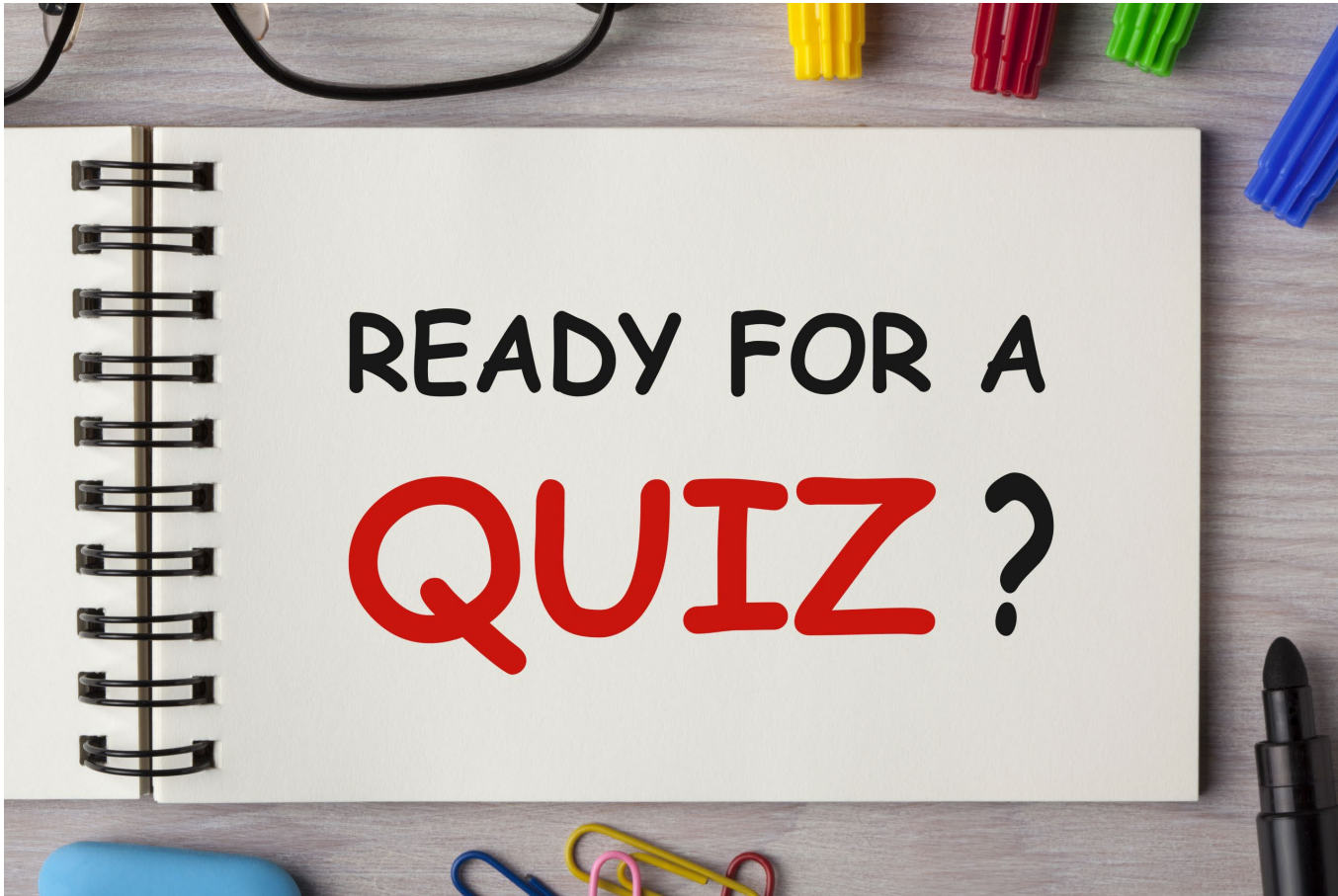

C  R





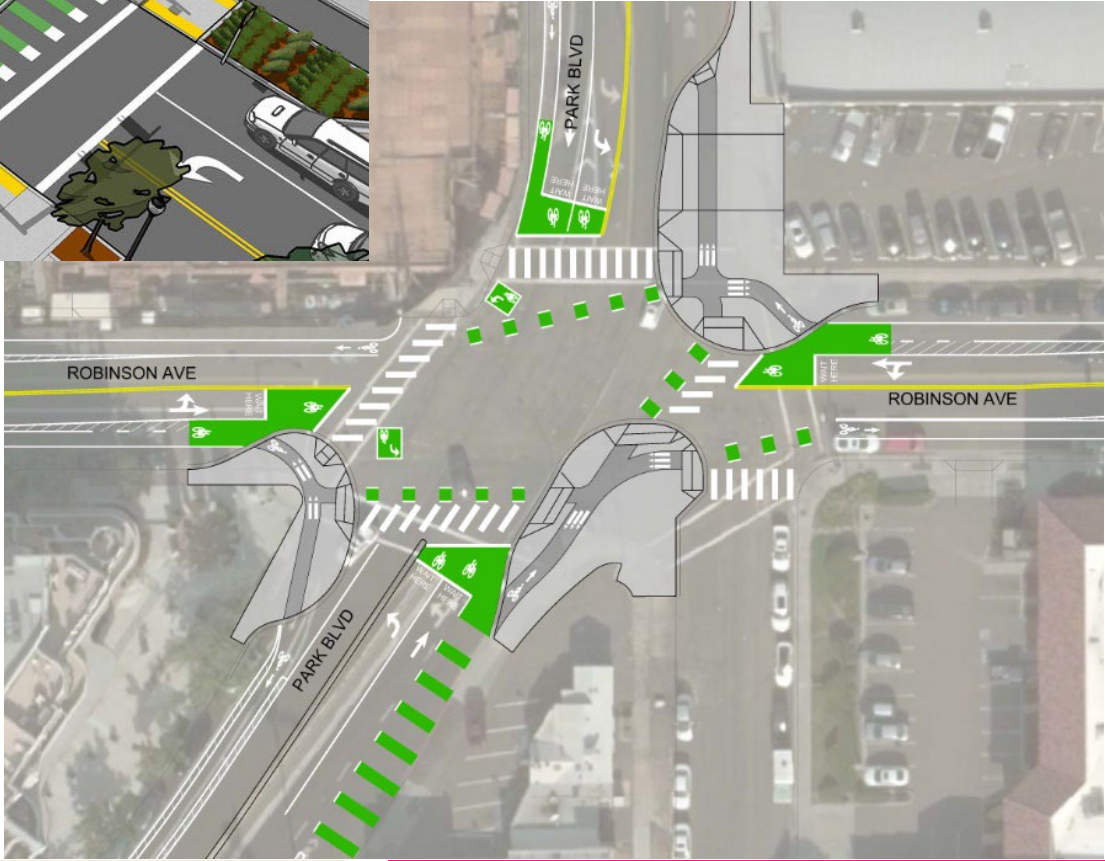



TODAY'S CR ASSOCIATES

Mission Statement

To Provide Innovative Mobility Solutions For Our Changing World!



TODAY'S CR ASSOCIATES

Vision...



...to reality



Roundabouts Objectives:

- + Simplify complex intersections
- + Function as gateway elements
- + Opportunities for public plazas
- + Improve connectivity to transit and neighborhoods
- + Enhance public safety

Roundabout Composition:

- + Single lane roundabout
- + 100 foot external diameter with 50 foot internal diameter
- + Provides public plaza opportunities on the northeast and southwest corners
- + Plan for removable bollards in some locations where community events may take place on the street



EL CAJON BLVD + PALM AVENUE GREEN STREET WITH "GARDEN" SEATING



THIS CONCEPT IS INSPIRED BY THE EXISTING PLANTING IN THE EXISTING MEDIANS ON EL CAJON BLVD. THIS CONCEPT INCORPORATES AREAS FOR SEATING UNDER LARGE CANOPY SHADE TREES AND LANDSCAPE AREAS WITH PLANTING COMPLIMENTARY TO THE MEDIAN PLANTING

CONCEPT SUMMARY:

- EL CAJON BLVD: TREES LARGE CANOPY SHADE TREES AT SIDEWALK, FLOWERING ORNAMENTALS AT ROUNDABOUT
- PALM AVENUE TREES: 2 SPECIES - SMALL SCALE EVERGREEN TREES AND FLOWERING ACCENT TREES, BOTH APPROPRIATE FOR PLANTING UNDER POWER LINES
- UNDERSTORY PLANTING: MIX OF FLOWERING NATIVE SHRUBS, GRASSES AND SUCCULENTS
- SEATING AREAS BETWEEN PLANTING FOR CAFE TABLES OR BENCHES
- PARKLETS AT ROUNDABOUT WITH SEAT WALLS AND ACCENT PAVING
- DECORATIVE CROSSWALK PAVING AT ROUNDABOUT
- STORMWATER TREATMENT INTEGRATED INTO PLATING AREAS

SCALE: 1" = 120'-0"

0' 60' 120'

↑ N

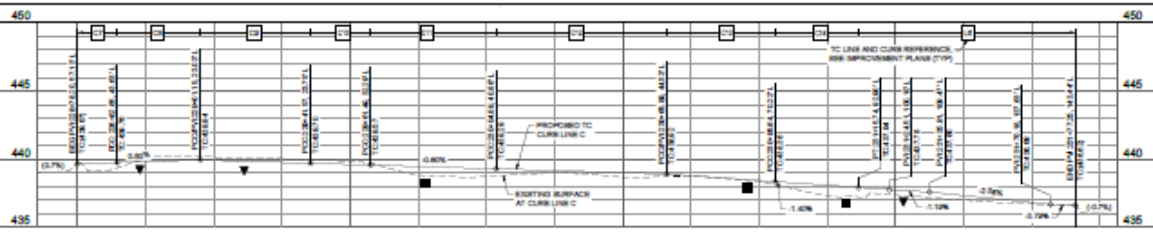

GENERAL NOTES:

1. VERIFY THE EXISTENCE AND HORIZONTAL/VERTICAL LOCATION OF ALL UTILITIES WITHIN THE PROJECT AREA THAT MAY CONFLICT WITH THE PROPOSED CONSTRUCTION. VERIFY THAT ANY UTILITIES SHOWN TO BE RELOCATED BY OTHERS HAVE BEEN RELOCATED AND NO CONFLICT IN CONFLICT.
2. SEE IMPROVEMENT PLANS FOR PROPOSED IMPROVEMENTS.
3. SEE STAKING PLANS FOR PROPOSED GEOMETRY AND ADDITIONAL DESIGN INFORMATION.
4. SEE DRAINAGE AND UTILITY PLANS FOR DRAINAGE AND SEWER IMPROVEMENTS.

REFER TO STAKING PLANS FOR ADDITIONAL TO AND H. DATA.

LEGEND:
 APPROXIMATE LOCATION OF DRIVEWAY, SEE STAKING SHEETS.
 APPROXIMATE LOCATION OF ADA CURB RAMP, SEE STAKING SHEETS.

CURB LINE C TO PROFILE
 HORIZ. 1" = 30'
 VERT. 1" = 4'

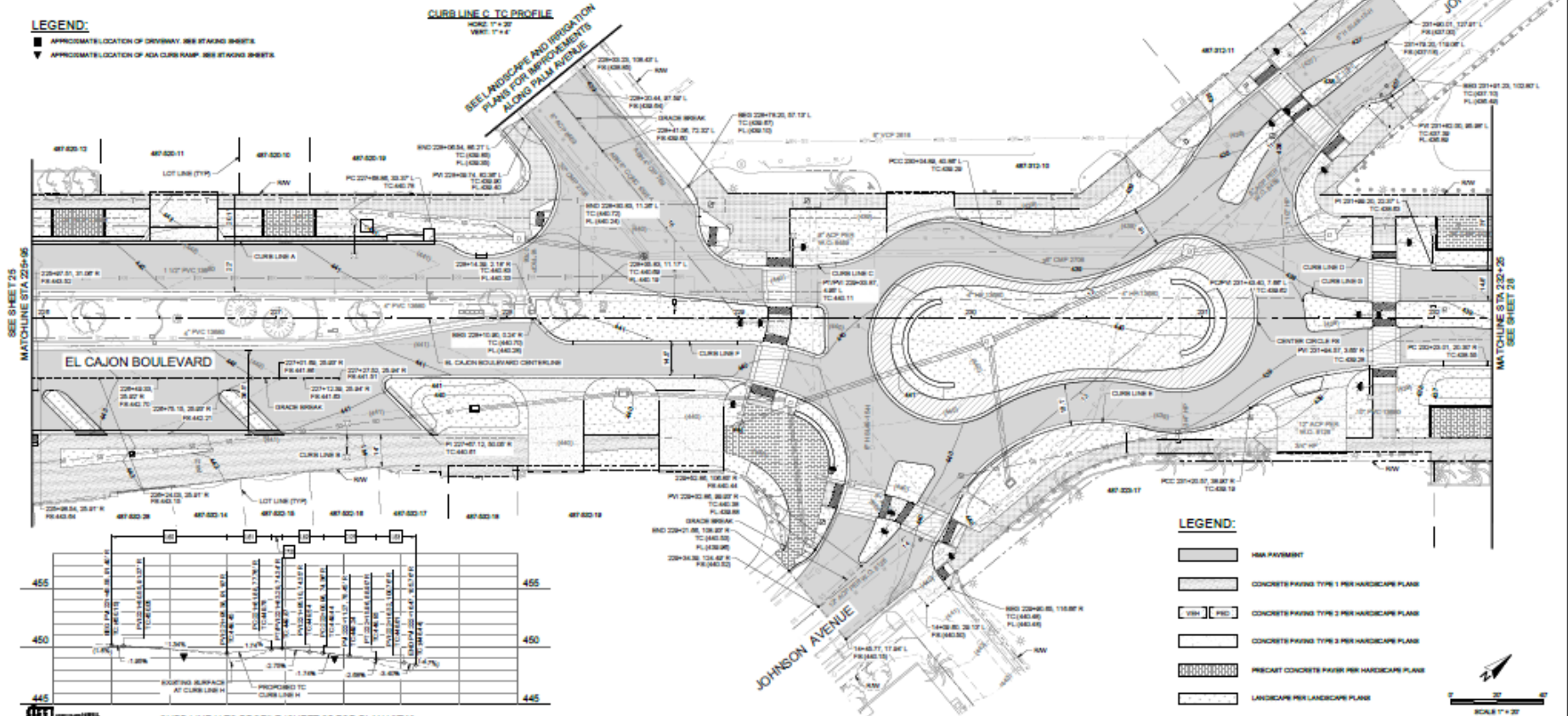

SEE SHEET 25
 MATCHLINE STA. 225+95

MATCHLINE STA. 232+25
 SEE SHEET 26

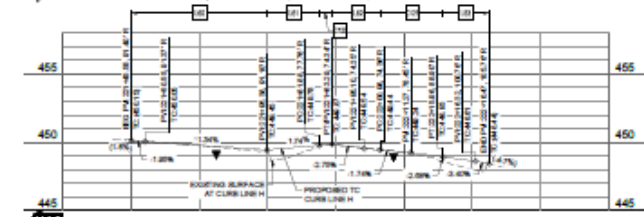

CURB LINE H TO PROFILE (SHEET 25 FOR PLAN VIEW)
 HORIZ. 1" = 30'
 VERT. 1" = 4'

- LEGEND:**
- HMA PAVEMENT
 - CONCRETE PAVING TYPE 1 PER HANDBICAP PLAN
 - CONCRETE PAVING TYPE 2 PER HANDBICAP PLAN
 - CONCRETE PAVING TYPE 3 PER HANDBICAP PLAN
 - PRECAST CONCRETE PAVER PER HANDBICAP PLAN
 - LANDSCAPE PER LANDSCAPE PLAN



AS BUILT

CONSTRUCTION RECORD		CITY OF EL CAJON	
DATE STARTED		PUBLIC WORKS DEPARTMENT	
CONTRACTOR		DESIGNED BY	APPROVED BY
DATE COMPLETED		DRAWN BY	CHECKED BY
INSPECTOR		ISSUED BY	FIELD NO.

EL CAJON BOULEVARD STREETSCAPE

PLAN AND PROFILE

SHEET NO. **25**
 OF 58 SHEETS
 ENGINEERING DIVISION JOB NO.
PW3690
 DRAWING NO.
14619







So why started CR Associates?



CHILDHOOD DREAM

What would you like to be when you grow up?



MOVING TO AMERICA

*Very interesting
and I would like to
design one of
these!*



COMPREHENSIVE EXPERIENCE IN TRANSPORTATION

- Engineering Design
- Traffic Operations
- Corridor Planning & Alternative Analysis for Freeway and Transit Projects

FOUND PASSION AND MY CALLING

**Complete Streets Act (AB 1358)
signed into law in 2008!! 😊**

ESTABLISHED “CHEN RYAN” IN NOVEMBER 2011



Monique Chen, PE



Sherry Ryan, PhD

STRATEGIC GROWTH

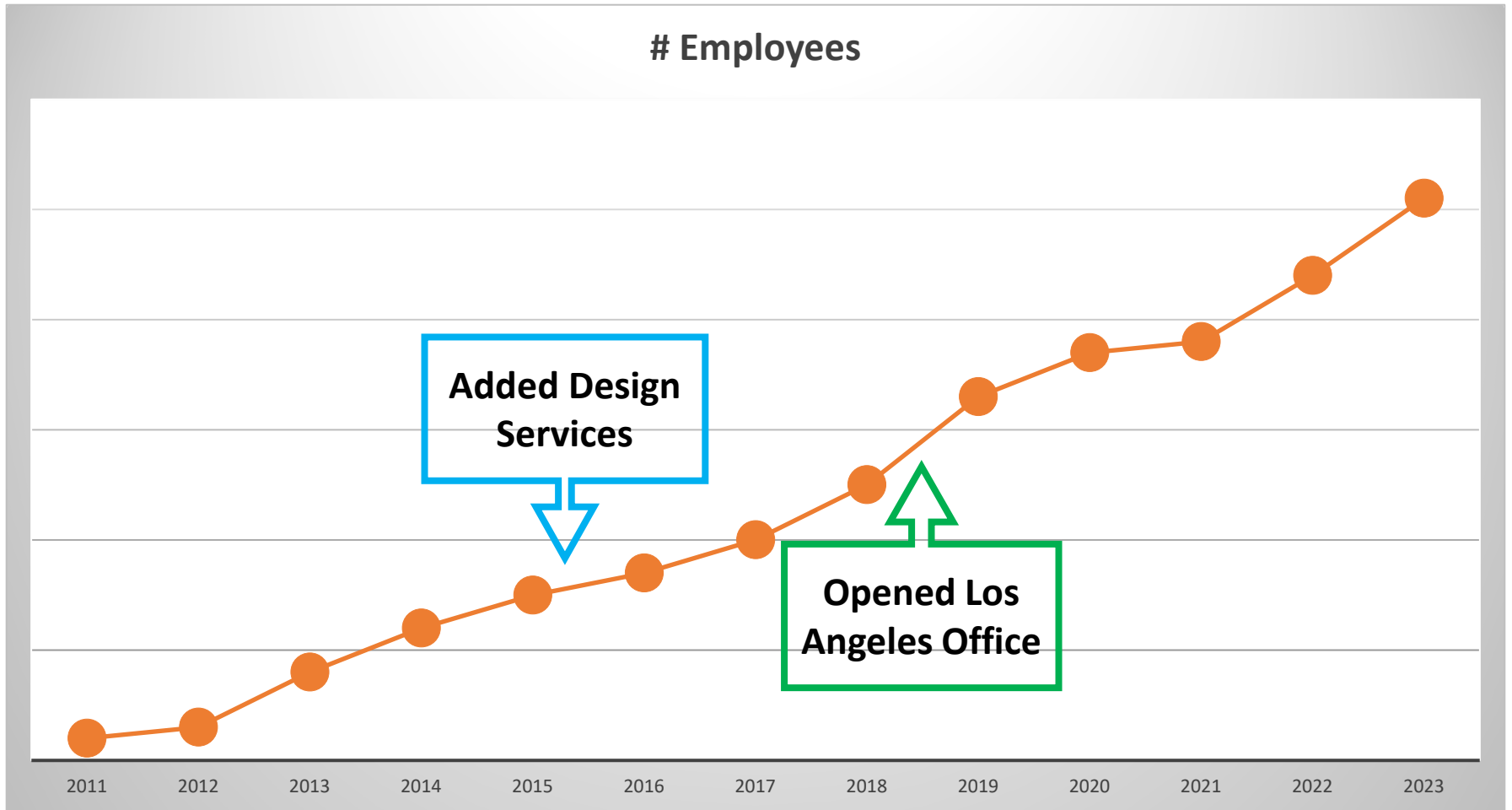

A CULTURE OF INCLUSIVITY AND BELONGING

Longevity and Loyalty Employees

- 10+ years: Over 10%
- 5+ Years: Over 30%

Diverse group of shareholders

- Over 35% of employees are shareholders

CR ASSOCIATES' CORE VALUES

- Respect
- Ethics
- Integrity
- Quality
- Innovation
- Accountability
- Empower
- Community



COMMUNITY CONNECTIONS - INTERNAL



COMMUNITY CONNECTIONS - EXTERNAL



IN CLOSING...

Leadership is not just a title or a position of authority; rather, it is a mindset, a commitment, and a relentless pursuit of excellence.

